



Bandido 90

- ☆ Explorer Yacht
- ☆ 3-Deck-Layout
- ☆ Master Cabin on Main Decl
- ☆ Transatlantic Range
- ☆ VAT paid
- ☆ Pristine Condition



Drettmann Yachts GmbH
Arberger Hafendamm 22
28309 Bremen
+49 421 566070
brokerage@drettmann.com



Bandido 90



Length

27.90 m

Year

2009

Engines

2x MAN D 2842
LE 410

Speed (Cruising / max.)

11 kn / 13 kn

Guests / Cabins

10 / 4

Bathrooms

4

Beam

7.70 m

Material hull

Steel

Power

2x 809 kW
2x 1100 PS

GRT

230

Fuel Tank approx.

38,000 l

Crew / Cabins

4 / 2

Draft

2.45 m

Material superstructure

Aluminium

Drive

Shaft

Class

pleasure

Flag

German

Location

Croatia

4,800,000 €

incl VAT



Bandido 90

The motor yacht "MOCEAN" is an impressive 2009 Bandido 90 that offers luxury and adventure in one. With its 2x 1100 HP MAN engines, it is powerful and ready for exciting transatlantic journeys. The hull of this yacht is made of steel, making it particularly sturdy and seaworthy, while the superstructure is constructed from aluminum, giving it a lightweight and stylish appearance.

With a total of three decks, the "MOCEAN" provides ample space to accommodate guests in exclusive comfort. The main deck features a spacious lounge and a dining area where you can savor delicious meals prepared by your private chef. The interior spaces are tastefully decorated, exuding elegance.

On the upper deck, you'll find a stunning sky lounge with panoramic sea views, where you can spend relaxed evenings with friends and family. The sundeck not only offers a generous sunbathing area but also an impressive view of the surrounding landscape.

The "MOCEAN" stands out not only for its luxury and elegance but also for its impressive range. It is perfect for transatlantic voyages, allowing you to explore distant destinations without compromising on comfort and amenities.

While this Bandido 90 may be smaller in pure length compared to some 35-meter yachts, it impresses with its versatility and its ability to venture into remote waters. The "MOCEAN" is ready to embark on new adventures and create unforgettable memories for you and your guests.

Amenities

 Sun-Deck

 Air conditioning

 Stabilizers

 Stabilizers at anchor

 Tender Garage

 Underwater lights

 Satellite TV

 WiFi



Drive

Steering	Servo/hydraul.
Trim tabs	✓
Bow screw	1x hydraulic
Stabilizers	ABT Trac Zero-Speed - new 2021
Engine compartment fan	2 x
Speed	max. 12.5 kn / cruising 11.0 kn
Consumption	approx. 95 l/h @ cruising
Range	approx. 3,500 nm @ 10.0 kn

Engines

// Engine 1

Manufacture	MAN / D 2842 LE 410
Type	Inboard engine / Diesel (Turbo) / 12 cylinder (V-Form)
Power	809 kW (1100 PS)
Engine hours	4386 h (State 07.11.2023)
Drive	Shaft
Cooling	Dual circuit cooling
Operation	electric (4x)

// Engine 2

Manufacture	MAN / D 2842 LE 410
Type	Inboard engine / Diesel (Turbo) / 12 cylinder (V-Form)
Power	809 kW (1100 PS)

Engine hours	4384 h (State 07.11.2023)
Drive	Shaft
Cooling	Dual circuit cooling
Operation	electric (4x)

// Generator 1

Manufacture	Onan
Type	Generator / Diesel / 4 cylinder (in-line) / Sound cover
Power	55 kW
Engine hours	6898 h (State 07.11.2023)
Cooling	Dual circuit cooling

// Generator 2

Manufacture	Onan
Type	Generator / Diesel / 4 cylinder (in-line) / Sound cover
Power	55 kW
Engine hours	6833 h (State 07.11.2023)
Cooling	Dual circuit cooling

Tanks

Fuel tank	38,000 l
Water tank	6,000 l
Waste tank	1,000 l
Grey tank	1,150 l



Exterior

Exterior Designer	Drettmann Yachts & JC Espinosa
Flybridge	Seating group, Table, Sun pads, Hardtop roof, Flybridge single cover, Steering position
Skydeck	Seating group, Lounge, Table, Sun awning
Foreship	✓
Aft deck	Seating group, Table, Steering position
Teakdeck	Foreship, Gangboard, Stairs to the bathing platform, Bathing platform, Aft deck, Fly Bridge, Skydeck
Reeling	Sea railing, Bulwark, Wooden handrail
Anchor winches	Bow (2x el. control)
Anchor 1	160 m Chain
Anchor 2	160 m Chain
Winches	2x Aft deck
Window	Windshield wiper (4x), Windshield washer system, Clear view screen, Front window blower (Air condition)
Radar arch	Aluminium
Garage	Doppelgarage
Gangway	Hydromar
Bathing ladder	✓
Deck shower	✓
Deck washing system	✓
Other	2x 190 kg TW N-Pool HHP Anchors and superswivel NEW 2023

Interior

Interior Designer	Drettmann Yachts
Number of cabins	4 (without crew)
Berths	up to 10
Double beds	4x
Bathrooms	4x
Dayhead	1x
Dinette	Table & Chairs
Galley	✓
Pilothouse	✓
Deck salon	✓
Indoor helm station	✓
Bridge	✓
Side doors	5x
Kitchen-Equipment	Hob (Ceran field), Microwave, Oven, Coffee Maker, Extractor hood, Sink (Double sink), Dishwasher, Refrigerator, Wine refrigerator, Freezer, Ice Maker, Washing machine, Dryer
Other	Bar with icemaker, sink and fridge on the SKY deck

Crew

Crew area	Foreship, sep. Eingang
Pantry	Stove, Microwave, Sink, Refrigerator
Cabins	2



Berths	4
Bathrooms	1

Nautical

Echo sounder	Shipmate with daughter
Fishfinder	✓
Sumlog	Shipmate with daughter
Compass	Shipmate with daughter
Autopilot	Shipmate with daughter
Chartplotter	Simrad NSS Evo 3S with daughter, Screen integrated in radar
GPS	, integrated in plotter/radar
AIS	✓
VHF radio	Shipmate, GMDSS, Approval Sea
Radar	Simrad
SAT-Kom	✓
Wind measuring system	✓
Rudder angle indicator	2x

Electrical equipment

Power supply	Shore connection (2x), Cable master (1x), Electrical system 24 V, Chargers (Mastervolt), Converter (from 24 V to 220 V), Alternators (2x), Battery, Battery main switch
---------------------	---

Lighting	Deck lighting, Underwater spotlights (6x), Navigation lights
Spotlights	Search spotlight (electric, 2x)
TV / Audio	SAT antenna, TV (8x), Starlink Internet

Water / Climate / Heating

Water system	Pressurized water system (electric), Seawater treatment (250 Liters/h), Suction feces, Wastewater treatment, Warmwassersystem
Air conditioning system	8x, Type: heating/cooling
Heating	Type: Kabola, hot water
Floor heating	in bathrooms

Safety

Class	pleasure
Onboard pharmacy	✓
Anchor ball	✓
EPIRB transmitter	✓
Signal horn	✓
Ship bell	✓
Fire extinguisher	6x
Lifebelt	✓
Life jackets	✓
Life rafts	2x max. 10 Pers.



Extinguishing system engine room	✓
Fire alarm system	✓
Vessel monitoring	✓
Camera system	✓
Bilgepumpe	5x electric
Other	BÖNING monitoring at both control stations and in the crew; for ship monitoring, tank systems, camera system, engine monitoring



Refit

2023

Exterior

- Hull paint touch ups
- Repaired and repainted passerelle doors
- Windlasses Overhaul both gearboxes, new bearings, seals, oil and repaint
- Vinyl waterline added
- Added STARLINK Satellite internet antenna into dome on top deck
- 2x domes added on flybridge top
- New anchors and superswivels 2xHHP POOL N-anchors – WORTELBOER (190KG)
- Teak decks sanded and treated with SEMCO sealant
- Underwater moving parts treated with Prospeed
- Antifouling 4 layers (for 24 months) applied International Micron 350 (March'23)
- Polished hull and superstructure
- Liferrafts, LSA and FF system annual and 2-years survey done

Engineering

- Descaled complete A/C raw water cooling system
- Descaled and Flushed Main Engines cooling system
- Descaled and Flushed Generators cooling system
- Annual Main Engine service (September 2023)
- MAN Main Engines 4x Turbos overhauled
- MAN engines, fuel injectors serviced, intercooler and heat-exchanger removed, cleaned, tested and reinstalled (@4380 hrs, Nov 2023)
- Annual Service on Generators
- Generators Overhaul turbines
- Generators cylinder head compression ratio check
- Generators New Fuel injectors
- Generators Repaired exhaust muffler
- Generators checked valves clearance

- Stabilizers hydraulics installed cooling pump and reinvented raw water outlet for better performance and eliminating noises
- ABT TRAC Stabilizers Fins removed and replaced seals, bearings and fixed locking pins (5year service)
- Steering system hydraulics; retrofitted heat exchanger and pump for better oil cooling
- Watermaker redesigned raw water circulation system to eliminate flux noise on deck
- Garage new bilge pump and complete floor repaint
- Garage new air seal
- Garage door locking pins overhauled.
- Fixed Garage and gangway electronics and replaced defective sensors
- All valves checked and serviced, replaced 2 valves on sea water main intake manifold
- New electronic motherboards for the A/C system compressors.
- Pumps Grey and Black water overhauled.

Galley

- Refurbished woodwork

-

Bridge

- Installation of two new 19" touchscreen displays and TIMEZERO Navigator
- New Arylic sound system merged with original Bose system on all 3 decks (handle music from smartphone)
- Simrad transducer DST810 New
- New LCD TV
- Installation of WiFi range extenders TPLink Deco system
- Setup of anchor alarm and wind alarm mirroring to Crew Mess for Live monitoring

2020/2021

Exterior

- Respray hull Agate grey with Awlcraft 2000
- Touch up and re-spray various white superstructure spots
- Regalvanize both chains
- Sandblast underwater hull, and complete an epoxy barrier coat treatment with new antifouling
- Installation of new Seatel TV dome 'M9' Antenna for good coverage
- Installation of new Simrad Halo Radar



- Installation of 'Mocean' name, backlite with high quality polished stainless steel
- Fabrication of a new swim ladder
- Fabrication of a flip up captain's table on the top deck by the navigation station
- Replacement of flybridge ice machine.
- New Mat's, towels, teak shoe box
- New Bridge deck stone table and chairs
- New Flybridge sunbeds and small stone table
- New exterior upholstery on all the cushions, re-designing of all the exterior seating areas

- Re-bronze of ship's bell
- Sanding of teak decks

- New liferafts
- New lifejackets

Engineroom

- Installation of new TRAC Zero speed stabilisers with new hydraulic pump – very effective at anchor.
- Servicing of waterpumps, airconditioning sea water pump, exhaust valves, sea strainers
- Cleaning and recoating of freshwater tanks, blackwater tanks, greywater tanks
- Opening and cleaning day fuel tanks
- Replacement of shaft cutlass bearings
- Pulling both shafts and balancing the propellers
- Changing anodes
- Replacement of Low pressure watermaker pump
- Repainting the tender garage
- Installation of 4 new underwater lights
- New crewmess greywater pump system
- New hydraulic oil
- New alternators on both generators
- New battery charger for main engine
- New bearings in the ventilation fans
- Servicing of engines and generators
- New electronic motherboard for the airconditioning

Bridge

- Installation of new stabiliser control panel

- Installation of Simrad NSS Evo 3S touch screen plotter/radar
- New high speed printer/scanner
- Replacement of Boning Navigation light module
- Work on Boning system to remove bugs and issues
- New Minipluxe 3E Shipmodul for NMEA over wifi
- Setup of anchor alarm and wind alarm monitoring on crew mess computer

Interior

Bridge deck

- New flat screen TV in dining area
- New marble dining table
- New marble floor and countertops in bar area
- New sink and tap in bar area
- New carpet
- New upholstery on bridge sofa
- New captain's desk chair
- Redesigning, modernising and upholstering of the dining sitting area

Main deck interior

- New decorative table for pots and plants
- New carpet
- New sofa design and upholstery
- New TV
- New TV lift system
- New carpet around TV area
- New marble counter, sink and faucets in dayhead
- Revarnished dayhead

Galley

- New fridges x 2
- New freezer
- New Miele cooktop
- New hidden trash bin
- New island on wheels
- New flip up stewardess coffee extension
- New marble flip up counter top extension for cooking



Owner cabin

- New flat screen TV
- New carpet
- New marble floor in bathroom and countertop
- New sink and faucets





MOCEAN

























































ERYACHTS A BOAT INTERNATIONAL PUBLICATION 2004
ERYACHTS A BOAT INTERNATIONAL PUBLICATION 2001





X
Y
Z
A
B
C
D
E
F
G
H
I
J
K
L
M
N
O
P
Q
R
S
T
U
V
W
X
Y
Z

A
B
C
D
E
F
G
H
I
J
K
L
M
N
O
P
Q
R
S
T
U
V
W
X
Y
Z





A B C D E
F G H I J
K L M N
O P Q R
S T U V W
X Y Z









A B C D E
F G H I J
K L M N
O P Q R
S T U V W
X Y Z













































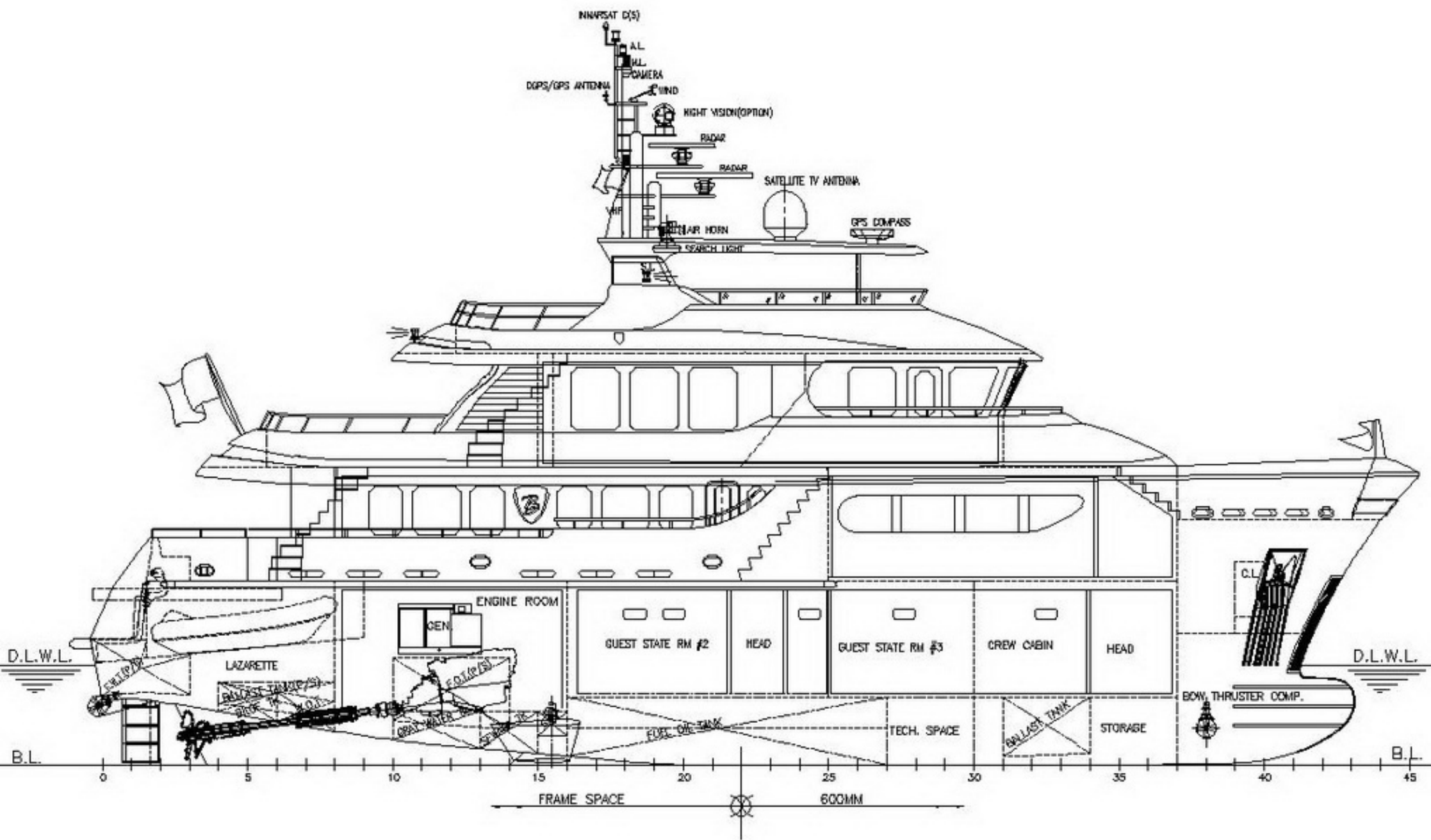

FLY BRIDGE

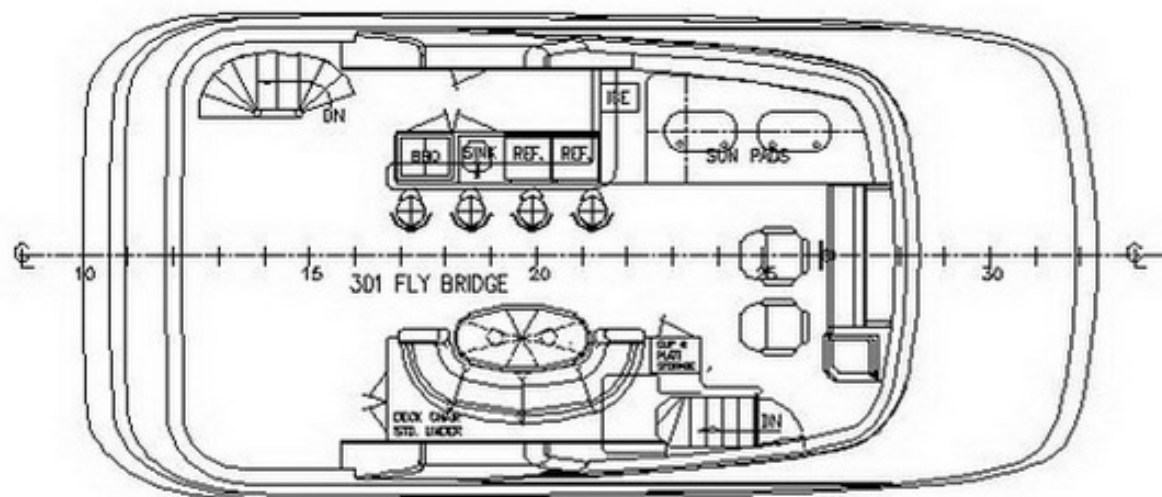

SUN AWING

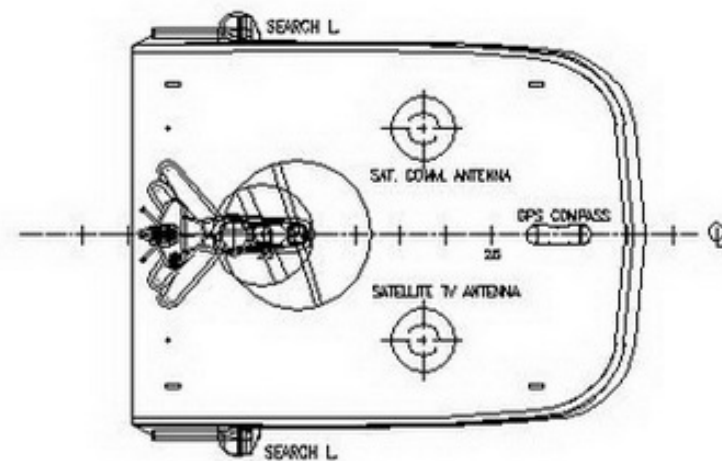

BRIDGE DECK

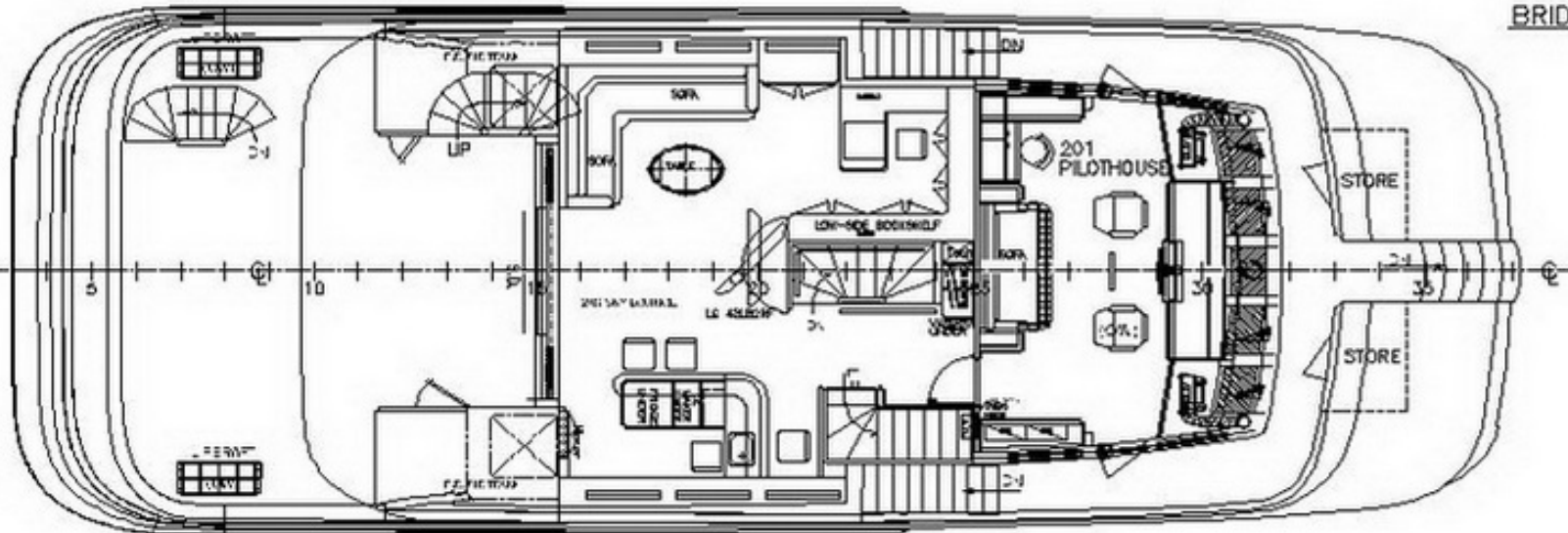

MAIN DECK

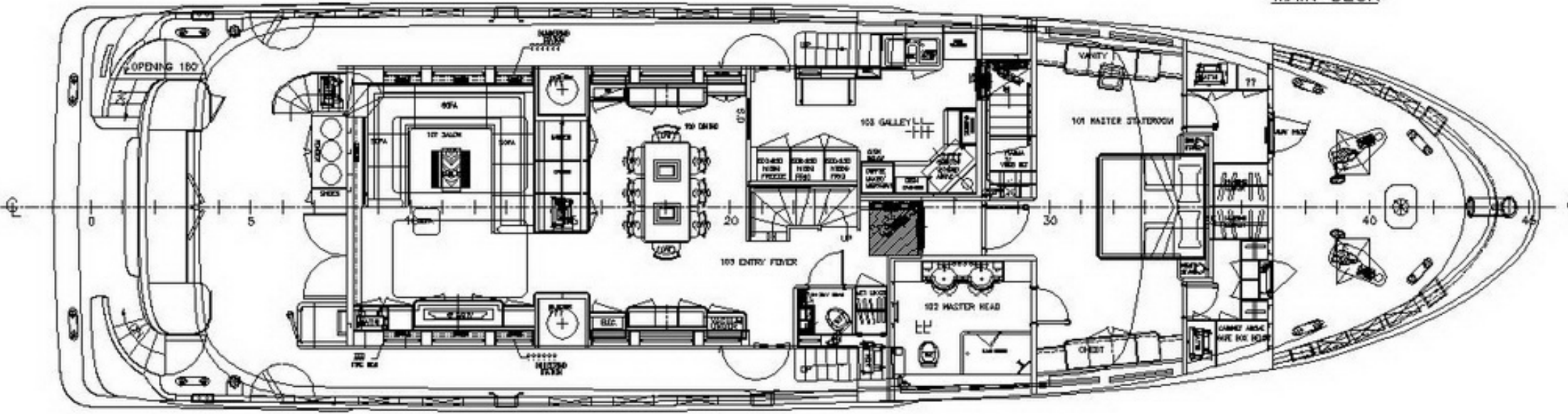

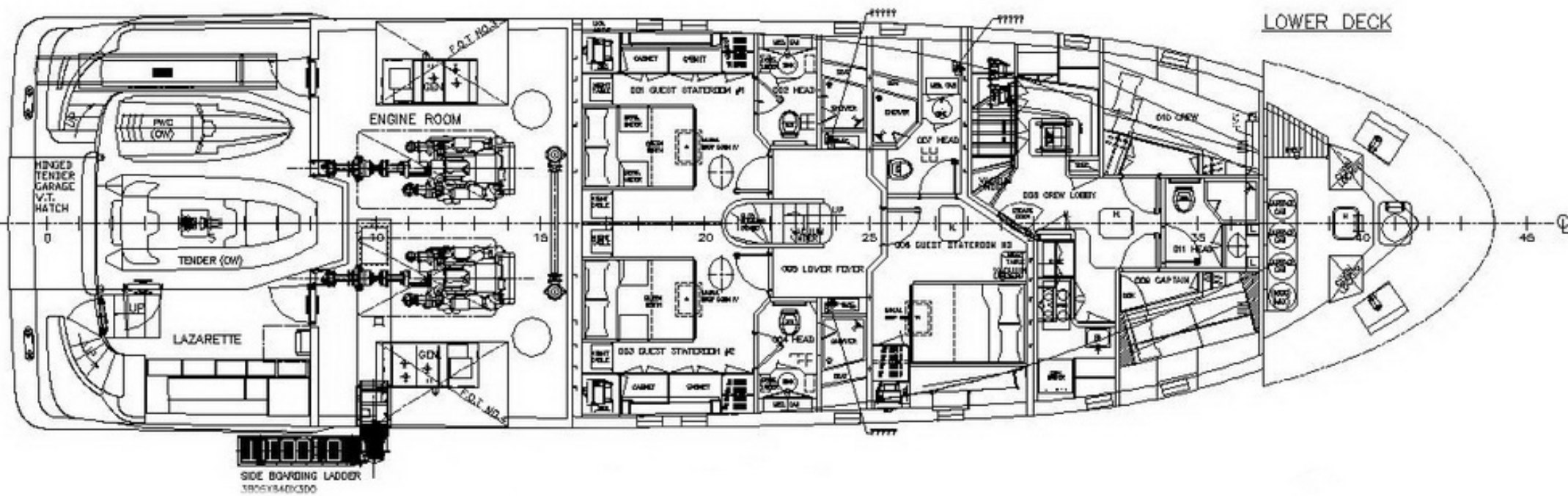

LOWER DECK

SIDE BOARDING LADDER
38051540X350



DRETTMANN YACHTS

BREMEN · GERMANY · SINCE 1970

drettmann.com